

IT/SH/19400

16 February 2023

Sam Ollis
Condor Motorsport Club
108 Paul Street
LOCHGELLY, Fife
KY5 9AW

Dear Sam,

RE: MEMORIAL GARDEN STAGES + JUNIORS
25th March 2023
Permit No: 130238 & 130239

Thank you for your application, in accordance with R26.6.2, to run 30 second starts. This is authorised for all stages and your stage diagrams are approved, this also includes for 30 second starts.

Notwithstanding the provisions contained in R24.4.12 and R24.4.13, at all venues issued with a Motorsport UK Track Licence ALL non-competing vehicles MUST be parked behind the circuit safety barriers during the normal running of a special stage. At all other venues the 30m provision in R24.4.13 is the MINIMUM distance that a non-competing vehicle may be located from the edge of the stage. The nature of the stage, weather conditions etc, must be taken into consideration and the distance that non-competing vehicles are stationed from the edge of the stage increased accordingly.

The granting of this permission does not preclude the right of the Motorsport UK Steward or Event Stewards where no Motorsport UK Steward is appointed from requesting alterations on the grounds of safety.

Please ensure that this letter and the stamped diagrams are shown to the Motorsport UK Steward before the start.

This letter is only valid if it is an original and the diagrams are stamped by Motorsport UK.

Yours sincerely



JOHN RYAN
Sporting Director

c.c. Motorsport UK Steward via e-mail only – Clayton Lackenby



CONDOR MSC

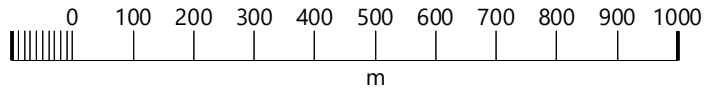

Mapping produced for Condor MSC by Nicolson Digital Ltd, 3 Frazer St, Largs, KA30 9HP,
© Crown copyright and database rights 2023 OS 100057546, based on OS 1/25000 mapping and enlarged to approx 1/12500

Key:
Solid black line = wall/fence Grey shading = broken tar/gravel, avoid
Broken black line = tyre barrier / solid stage furniture
Blue = water (burn/pond etc) Stage route in RED
Orange = buildings, except rally HQ which is Red
Red M = Marshall Post

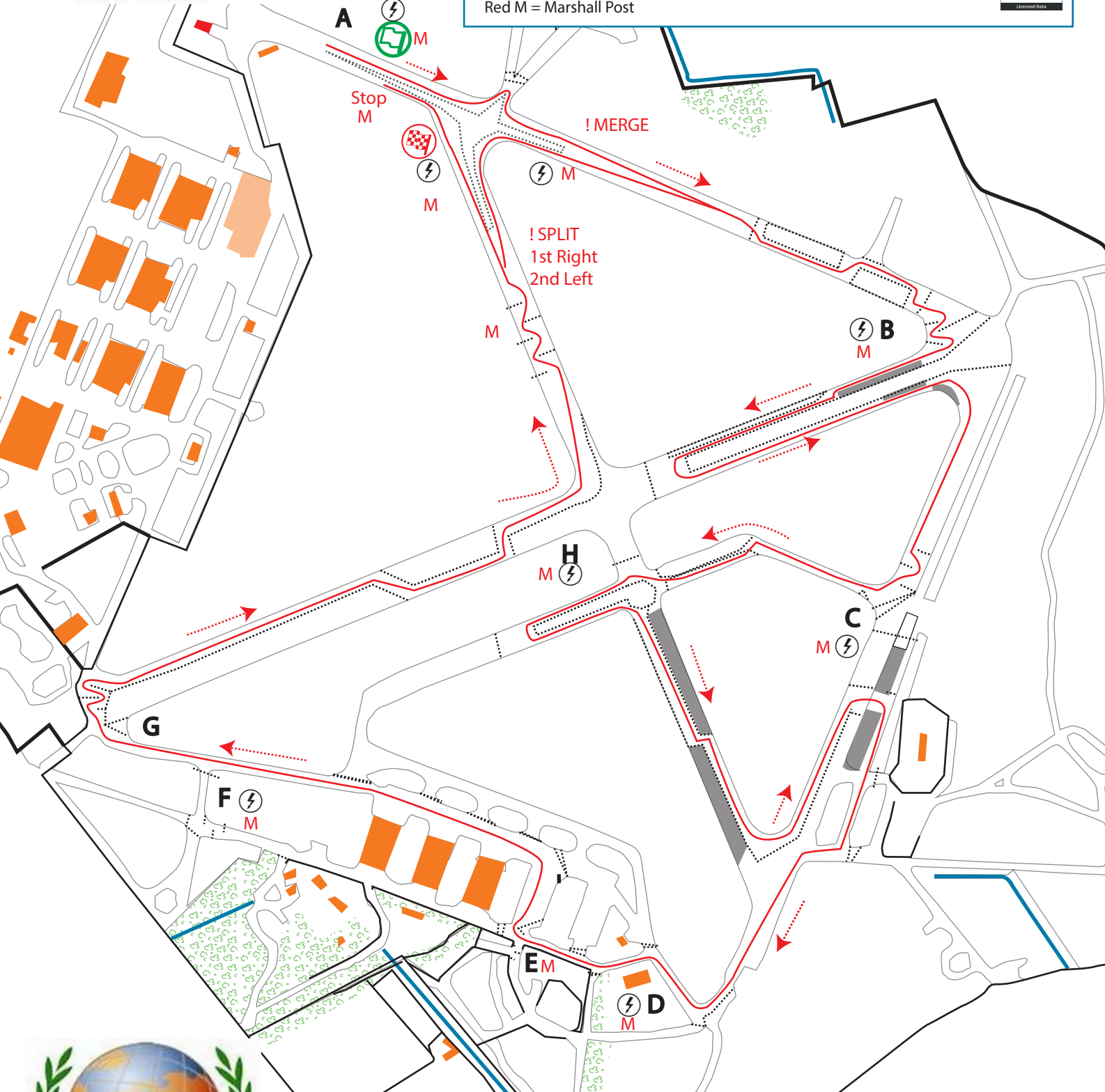

CONDOR MSC



P.P. [Signature]
RALLIES EXECUTIVE

Memorial Garden Stages
Stage numbers 1 & 2
6.9 Miles each
Version 7.0 060223



CONDOR MSC

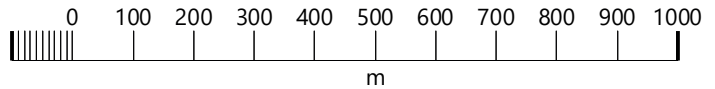

Mapping produced for Condor MSC by Nicolson Digital Ltd, 3 Frazer St, Largs, KA30 9HP, © Crown copyright and database rights 2023 OS 100057546, based on OS 1/25000 mapping and enlarged to approx 1/12500

Key:

- Solid black line = wall/fence
- Grey shading = broken tar/gravel, avoid
- Broken black line = tyre barrier / solid stage furniture
- Blue = water (burn/pond etc)
- Orange = buildings, except rally HQ which is Red
- Red M = Marshall Post

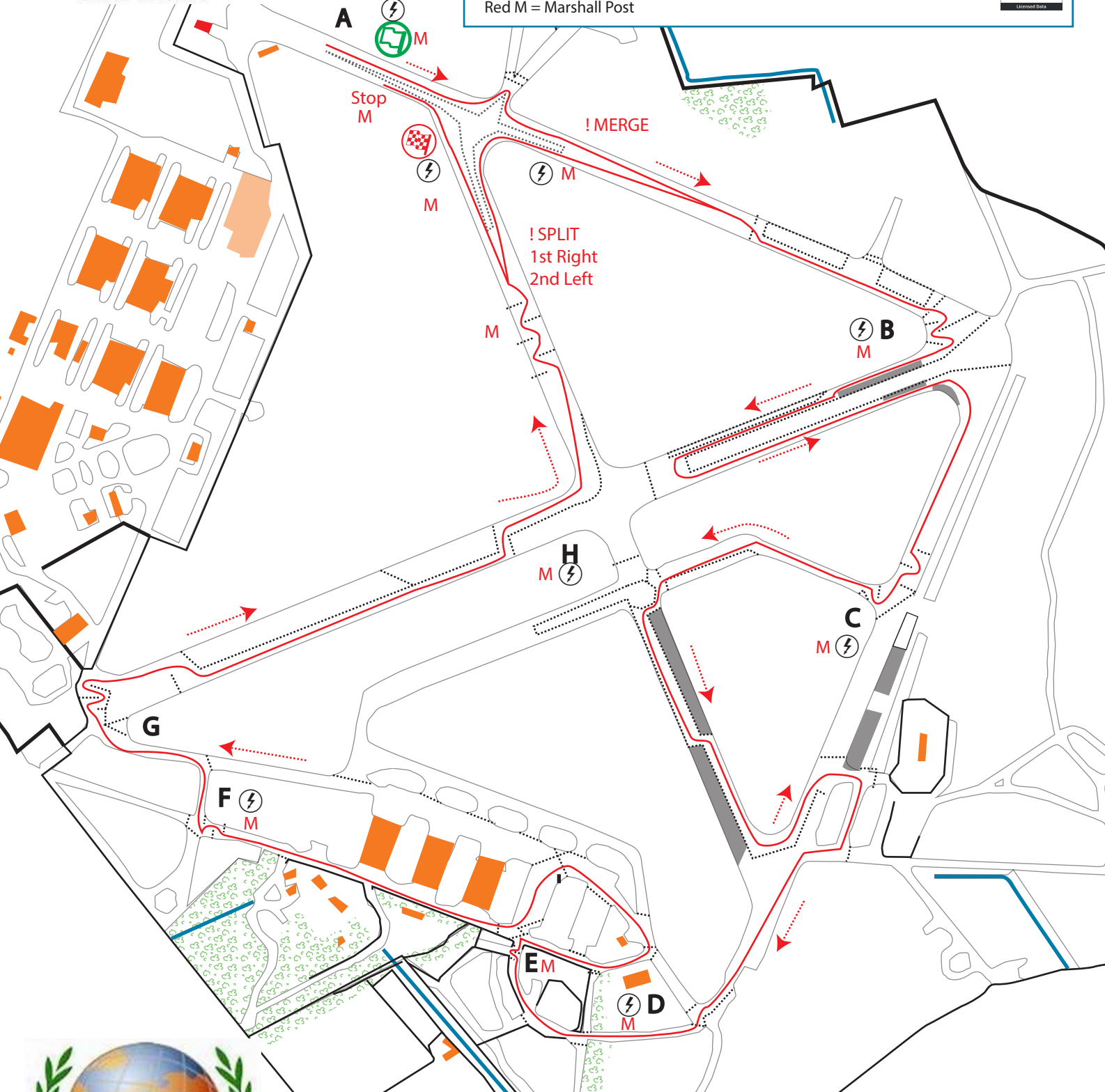

CONDOR MSC



PP. [Signature] RALLIES EXECUTIVE

Memorial Garden Stages
 Stage numbers 3 & 4
 6.7 Miles each
 Version 7.0 060223



CONDOR MSC

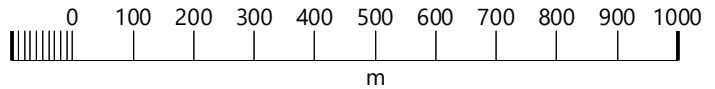

Mapping produced for Condor MSC by Nicolson Digital Ltd, 3 Frazer St, Largs, KA30 9HP, © Crown copyright and database rights 2023 OS 100057546, based on OS 1/25000 mapping and enlarged to approx 1/12500

Key:

- Solid black line = wall/fence
- Grey shading = broken tar/gravel, avoid
- Broken black line = tyre barrier / solid stage furniture
- Blue = water (burn/pond etc)
- Orange = buildings, except rally HQ which is Red
- Red M = Marshall Post

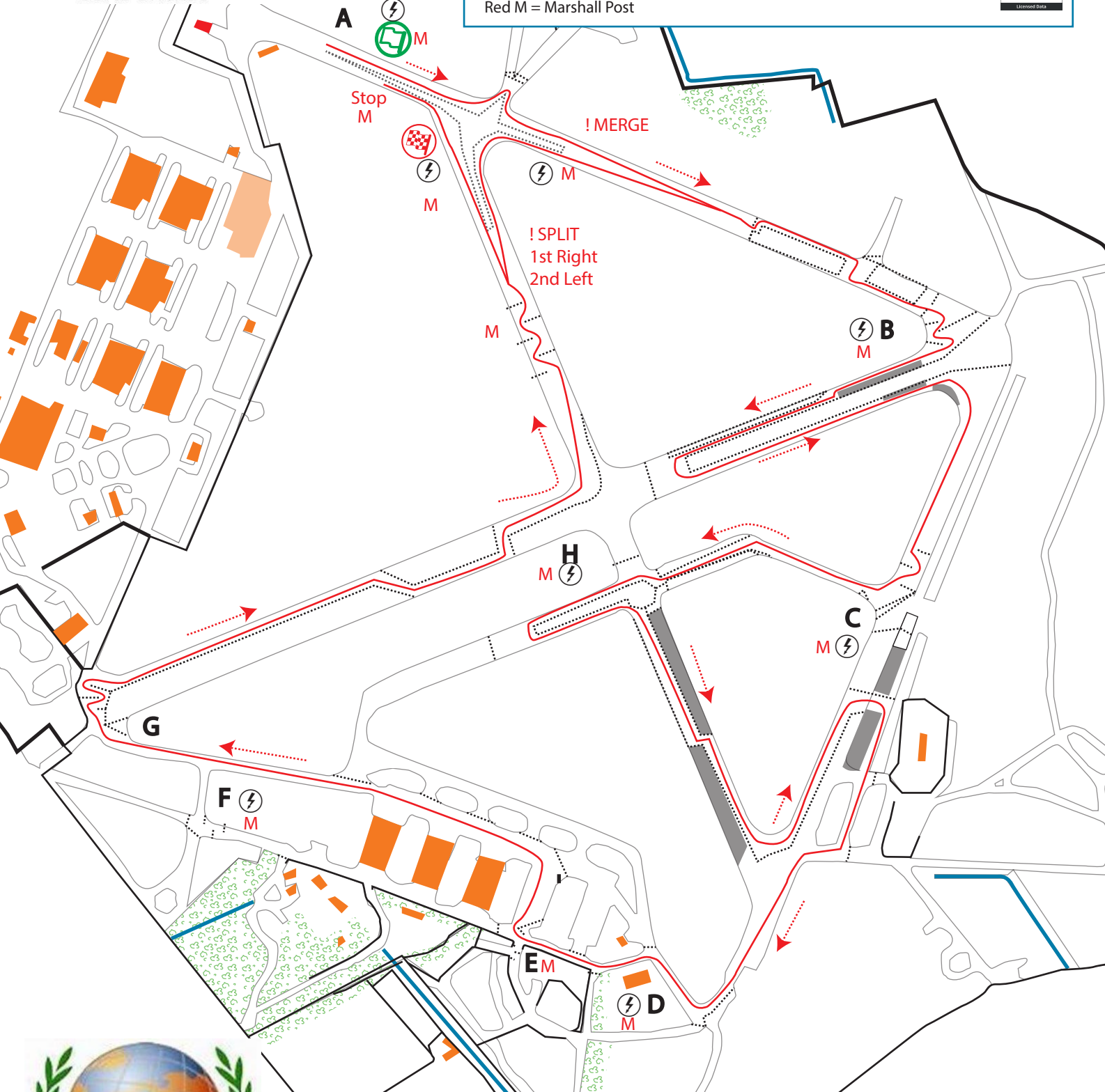

CONDOR MSC



PP. [Signature] RALLIES EXECUTIVE

Memorial Garden Stages
 Stage numbers 5 & 6
 6.9 Miles each
 Version 7.0 060223